

## Flush Mount Panel Adapters

- ▶ **Cost-effective solution.**
- ▶ **Easy installation.**
- ▶ **Flexibility of using any standard socket meter.**

### **DESCRIPTION**

These Panel Adapters allow the user to replace an old switchboard (panel mount) meter with a new standard socket meter, eliminating the need to stock or maintain more than one type of metering package. The panel socket adapter is a low cost way of converting an antiquated switchboard meter to a solid-state metering system using a socket meter. It requires no changes to the substation steel panel or its existing cutout for installation.

Many utilities have already standardized on socket meters, taking advantage of lower costs and simplified maintenance. These panel adapters provide an easy and convenient way of installing socket meters on panels, thus eliminating the need for more expensive switchboard meters. With these adapters, there's no need to keep an inventory of various meters or use switchboard meters at all.

The innovative Flush Mount Panel Adapter is adjustable, with ten field-selectable lengths for precise positioning. Its patented design allows for easy installation and maintenance. These adapters can be delivered quickly – no long lead times.

### **ADVANTAGES (New or Retrofit Installations)**

- ▶ Flexibility – the adjustable length accommodates all meters and various installation desires.
- ▶ Works with any standard socket meter.
- ▶ Less expensive solution than using switchboard meters.
- ▶ Ability to mount a lower cost industrial meter on a panel.
- ▶ Lower initial and replacement costs.
- ▶ Reduces meter and spare part inventory.
- ▶ Simplifies maintenance, testing and replacement.
- ▶ Easy installation – threaded mounting holes mate to existing panel holes & cutouts so existing metering can be replaced without changing the panel at all.
- ▶ Enables changing the meter or manufacturer any time.
- ▶ In stock models available for immediate delivery.



Adjustable Flush Mount Adapter (SWAAF5)



Fully Expanded Adapter (SWAAF5)

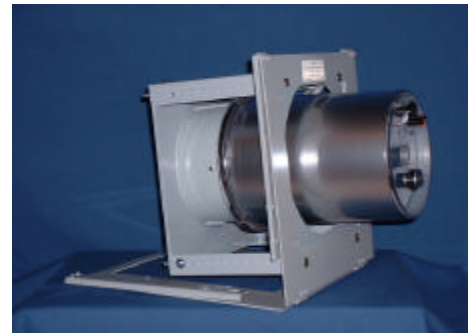

Fully Retracted Adapter in Demo Panel



Fully Expanded Adapter in Demo Panel

U.S. Patent 6,104,601

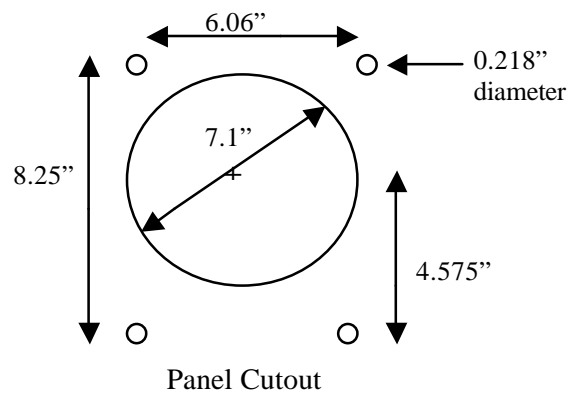
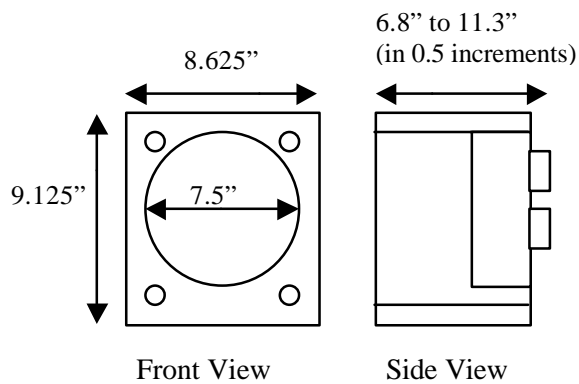

## PRODUCT AVAILABILITY

There are two models: Front Removal “F” and Universal “U”. The meter can be removed from the front or the back for the “F” model. Any standard socket based meter will fit into these adapters. The overall length of the adapter is user adjustable from 6.8” to 11.3” to accommodate all socket meters.

- Available forms are 9S, 6S, and 5S (2, 2 1/2 and 3 elements).
- Options: KYZ Output, Test Switch Plate, Test Switch, Large case adapter plate, Cover and AUX power.
- Contact Southern Utility Services, Inc. for custom hole patterns or non-standard installations.

## SUSI PART NUMBERS

**Flush Mount – Front Removal:** Recommended for new or existing installations or where the panel can be modified.  
In stock for immediate delivery

### SUSI PN    Meter Form    New Meter plugging    Mounting holes patterns for retrofits into Adapter

SWAAF9	9	Any Socket Meter	JEM10, Transdata, and others
SWAAF6	6	Any Socket Meter	JEM10, Transdata, and others
SWAAF5	5	Any Socket Meter	JEM10, Transdata, and others

**Flush Mount – Universal:** Recommended for retrofitting where the panel cannot be modified.  
Special Order - Rear removal of meter only - 4 weeks delivery

### SUSI PN    Meter Form    New Meter plugging    Mounting holes patterns for retrofits into Adapter

SWAAU9	9	Any Socket Meter	GE DS, JEM10, Transdata, and others
SWAAU6	6	Any Socket Meter	GE DS, JEM10, Transdata, and others
SWAAU5	5	Any Socket Meter	GE DS, JEM10, Transdata, and others
SWAAUJ9	9	Any Socket Meter	JEM1, JEM10, Transdata, and others
SWAAUJ6	6	Any Socket Meter	JEM1, JEM10, Transdata, and others
SWAAUJ5	5	Any Socket Meter	JEM1, JEM10, Transdata, and others

### Options

-K	KYZ Output (*In Stock)
-T	Test Switch Plate
-TS	Test Switch Plate & Test Switch
-P	Adapter Plate for Large case switchboard meters from Schlumberger, GE, L&G and Transdata.
-A	Adapter Plate for Large switchboard meters-Westinghouse(ABB)
-C	Cover for Flushmount Adapters

\*Shipping Weight Approximately 8 lbs. FOB Norcross GA

For More Information call **770-448-6810** or e-mail [sales@SouthernUtility.com](mailto:sales@SouthernUtility.com)

1030305/500

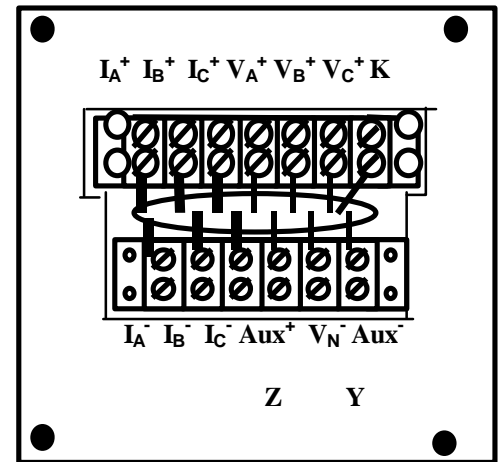

**Form 9S wiring diagram**