

## Westinghouse Retrofit Panel Adapter for Socket Meters

- *Cost-effective solution for upgrading old metering*
- *Retrofits into existing switchboard meter cases*
- *Easy installation. No re-wiring or de-energizing*

### DESCRIPTION

This new Retrofit Panel Adapter allows the user to replace an old Westinghouse switchboard meter with a new electronic socket meter. This replacement can be done in minutes without de-energizing the circuit or re-wiring anything. Simply open the test switches, then remove the old cradle (meter) and plug in the Retrofit Panel Adapter (SWRWS). Easy installation translates into lower labor costs, which in turn makes the meter upgrade feasible for many applications.

With this retrofit package you can cost effectively offer your customer the newest metering technology without shutting down their circuit or being concerned about miswiring. No more concerns about how to handle the asbestos wiring. Don't handle it at all. Once this Retrofit has been installed, your customer will have the benefit of a standard socket interface for any future meter testing or upgrades. Many utilities have already standardized on socket meters, taking advantage of lower costs and simplified maintenance. Using socket meters eliminates the need to stock or maintain more than one type of metering package. And you will not have to pay for the higher priced switchboard metering anymore.

This Retrofit Panel Adapter is the newest addition to the comprehensive Panel Adapter family of products, which includes the Flush Mount and Surface Mount Adapters as well as a number of options.

### ADVANTAGES (Retrofit Installations)

- ▶ Retrofit Adapter can also work with any standard socket meter.
- ▶ Lower initial and replacement costs.
- ▶ Less expensive solution than using switchboard meters.
- ▶ Ability to mount a lower cost industrial meter on a panel.
- ▶ Reduces meter and spare part inventory.
- ▶ Simplifies maintenance, testing and replacement.
- ▶ Flexible - change meter or manufacturer any time.
- ▶ In stock models available for immediate delivery.

US Patent 6,421,230



Retrofit Panel Adapter (SWRWS9)



Westinghouse Meter in Panel



Retrofit Panel Adapter installed



Retrofit Adapter installed with meter and cover

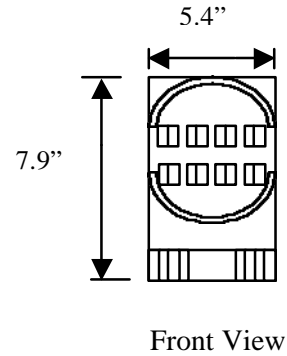
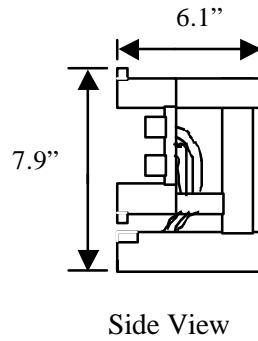
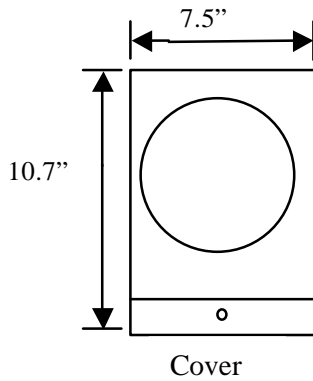

## PRODUCT AVAILABILITY

- Retrofit for the Westinghouse FT-21 case.
- Available forms are 9S, 5S, and 6S (2 and 3 elements).
- Options: KYZ Output and Auxiliary Power.
- Cut-out for the meter's I/O or communications cable is standard.
- For other cases such as GE or the large case Retrofit Adapters contact Southern Utility Services, Inc. or your local manufacturer's representative.

## SUSI PART NUMBERS

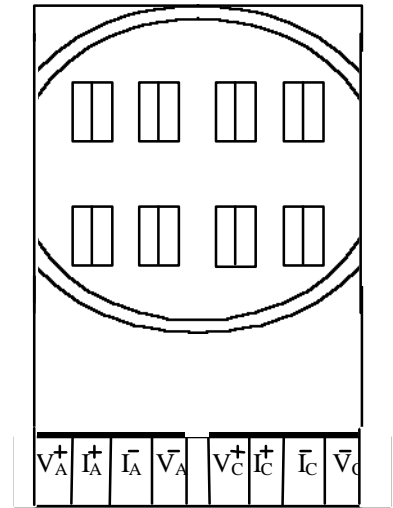

**Form 5S (SWRWS5)  
wiring diagram**

### Retrofit Panel Adapters

**SUSI PN**    **Meter Form**    **New Meter plugging**    **Retrofits into**  
**into Adapter**

SWRWS9	9	Any Socket Meter	Westinghouse FT-21 case
SWRWS6	6	Any Socket Meter	Westinghouse FT-21 case
SWRWS5	5	Any Socket Meter	Westinghouse FT-21 case

### Options

-K	KYZ Output and Auxiliary Power
----	--------------------------------

\*Shipping Weight Approximately 6 lbs. FOB Norcross, GA

For More Information:

**Call: 770-448-6810**

**Email: [sales@SouthernUtility.com](mailto:sales@SouthernUtility.com)**

**Web site: [www.SouthernUtility.com](http://www.SouthernUtility.com)**